

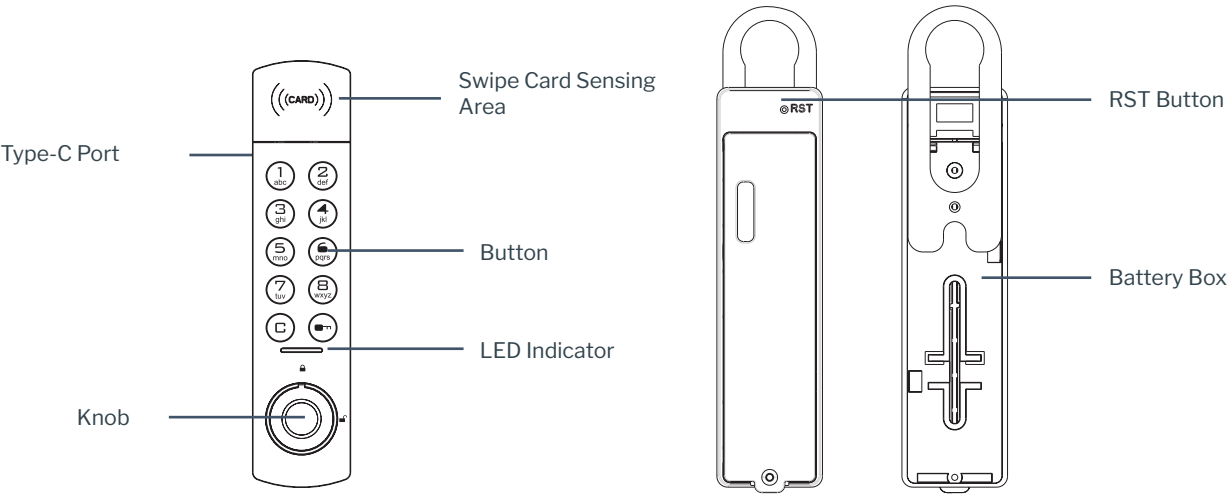

Keyfree 310, 320

RFID Keypad Lock Instructions



Technical parameters

Management password	4321
User password	1234
Working temperature	-20 ~ + 55°C
Storage temperature	- 40 ~ + 55°C
Working humidity	10% ~ 85% RH
Management card	3
User card	20
Static current	<40uA
Dynamic current	<100mA
Batteries life time	≥3000 times
Power supply	4×AA Alkaline battery

1. How to operate

- 1. Factory default user code 1234, factory default management code 4321.Card database is empty, card can not unlock before added.
- 2. Private mode or public default, mode is private mode.

2. Lock & Unlock

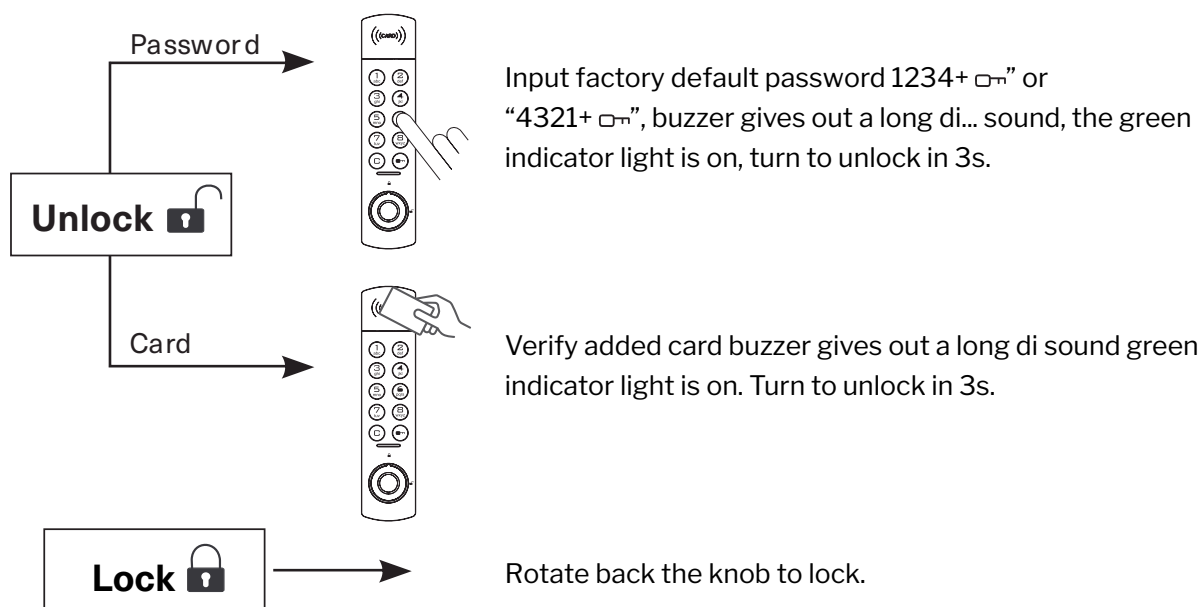

Note:

- When password/card is wrong alarm sounds di..di..di.. 3 times
- When pressing the key, a red light will flash. After entering the correct password, there will be three short beeps, and the red light will remain on, indicating normal unlocking
- When using the management password, the user password will be changed back to original password: 1234

3. Setting password

A. Change management password

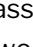
1. Input current management password 4321+C buzzer gives out a long di... sound, the green indicator light will flash
2. Input new management password *****+  when you heard a long di... sound means management password already been changed

Note:

Password can consist of 4~15 digits

B. Change user password

1. Input current user password 1234+C , buzzer gives out a long di... sound , the green indicator light will flash
2. Input new user password *****+ □, when you heard a long di sound means user password has been changed



Note:

- Password can be consisted of 4~15 digits, password can not be the same as the management password
- When using the management password, the user password will be changed back to original password: 1234

4. Setting cards

A. How to add cards (2 ways)

1. Input current management password, press “C”, buzzer gives out a long di... sound, the green indicator light will flash
2. Hold card to close to inductive zone , buzzer gives out a long di... sound, added successfully, this new card will be management card, you can continue to add other card as management card (3 at most)

-
1. Use management card 1 time , you will hear a long di... sound and see the green indicator light is on
 2. Use management card again , the green indicator light will flash
 3. Take any other card to be added , when you hear a long di... sound, this new card will be user card, you can continue to add the other user cards (20 at most)

Note:

- Management card is with unlocking and deleting user card function management card and user card can not be the same card.
- A maximum of 3 management card and 20 user cards can be added.

B. How to delete single user card

1. Use management card 3 times, you will hear a long di... sound and see the red indicator light flashing
2. Use user card you want to delete, heard a long di... sound , deleted successfully, you can continue to delete the other user card

C. How to delete all cards

1. Use management card 5 times, you will hear 2 long di di sound, deleted succeed

5. How to switch the mode

Turn on public mode, set temporary password/card

Turn on public mode

1. Input management password+ \square , buzzer gives out a long di sound, the green indicator light is on
2. Press \square at least 2s, the green indicator light flash, press again,
3. Input “4 4+ \square “, when you heard a long di sound means public mode already been turned on

Set temporary password

1. Input the new password consisted of 4-15 digits
2. Press \square , when you heard a long di... sound, the green indicator light is on, temporary password already been set



Set temporary card

1. Verify any card
2. When you heard a long di sound, the green LED is on, temporary card already been set



Note:

- After switch to public mode, management card need to be added again
- Under public mode, management code and management card can delete temporary code
- Temporary password/card can be used for 1 time only
- LED will flash every 3s when lock occupied

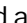
Turn off public mode

1. Input management password+ , buzzer gives out a long di sound, the green indicator light is on
2. Press  at least 2s, the green indicator light flash, press again
3. Input “4 3+ ”, when you heard a long di sound means public mode already been turned off

Turn on/off Fake Pin code function

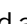
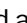

1. Input management password+ , buzzer gives out a long di sound, the green indicator light is on
2. Press  at least 2s, the green indicator light flash, press again,
3. Input “4 2+ ”, when you heard a long di sound means Fake Pin code function already been turned on
Input “4 1+ ”, when you heard a long di sound means Fake Pin code function already been turned off

Note:

Introduced with Anti-Theft Technology and Fake PIN password function you can input any code(s) before or after the real password to prevent the real password being observed.

Maximum 16 digits

6. Special function description

1. Decode: Press “RST” on the back of the control panel for 3s , when you heard a long di... sound , the password will be changed back to the original management password “4321”, user password “1234”; clear but do not unlock in private mode and Fake Pin code, clear and unlock do not restore the mode in public mode.
2. Auto-alarm will be activated when input wrong password 4 times and the lock will be died for 60s.
3. Battery low voltage prompts: When the buzzer give out di di di 3 times, and the red indicator light is on means battery at low voltage, pls place the battery in time, the lock may not work when the voltage is low.
4. Emergency power supply: When the battery is in low voltage condition, you can connect the Type-C port with an external power supply.
5. Tone/Mute mode switching (loop switching): Press and hold the , and the green light flash once to enable the silent mode; In silent mode, hold down the  and a long di... sound to disable the silent mode.

7. Fixing hole size & installation

Fixing hole size

Unit: mm

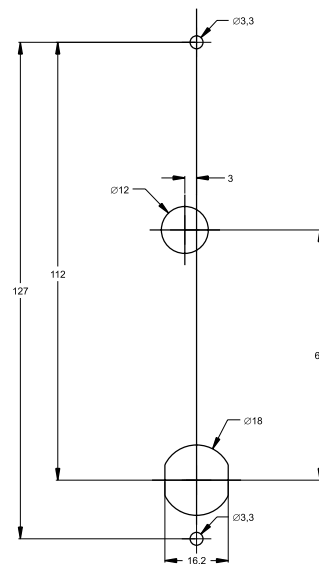

Wood panel

Installation

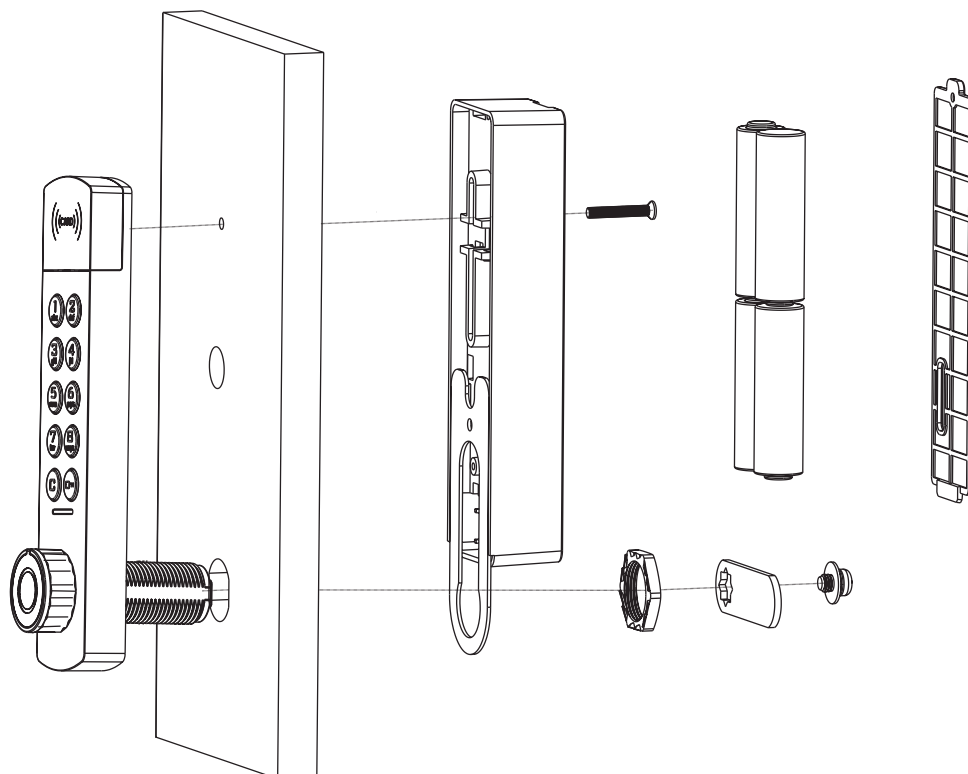

Suitable thickness for wooden door: 16-20mm

Suitable thickness for metal door: 0.6-2.0mm